

承 認 書

APPROVAL SHEET

承認书编号:

SHEET NO: _____

TO: _____

We are pleased in sending you herewith our specification and drawings For your approval.

Please return to us one “APPROVAL SHEET” with your approved signatures.

商 品 COMMODITY:	直滑
型 号 MODEL NUMBER:	2031N-B10k-10C
客户料号 PART NO	
日 期 DATE	2019年11月12日

客 戶 承 認 Customer Approved

供 应 商 經 辦 Supplier Handle by

一、外观要求: Appearance requirements					
序号NO.	项目 ITEM	性能PERFORMANCE			
1	产品外观 product appearance	产品无锈蚀、裂痕、电镀不良现象 Product without rust, crack, electroplating unhealthy phenomenon			
2	包装方法 Packing method	按产品规格包装 (数量正确, 型号料号符合……) According to the product specification packaging (with right quantity, type materials issue in compliance with ……)			
二、电气性能: Electrical characteristics					
序号NO.	项目 ITEM	性能PERFORMANCE			
1	全阻抗 Total resistance	10 K Ω \pm 20%			
2	抵抗变化特性 Resistance taper	<input type="checkbox"/> A <input checked="" type="checkbox"/> B <input type="checkbox"/> C <input type="checkbox"/> D <input type="checkbox"/> W			
3	残留阻值Residual resistance	R \leq 10K Ω \leq 10 Ω 10K<R<250K Ω \leq 20 Ω R \geq 250K \leq 0.1%max. of total resistance			
4	阻值变化特性范围 Resistance taper Characteristics	A50%	B50%	C50%	D50%
		15-25%	40-60%	75-85%	2-15%
5	定格电力ratings power	BTaper: AC500V0. 5W; Other Tapers: AC350V0. 25W			
6	联动差Gang Error	-40~0db \leq 3db			
7	滑动杂音Slider noise	100mV 以下 100mV max			
8	绝缘抵抗 Insulation resistance	DC250V, 100M Ω 以上 100M Ω min. at DC250V			
9	耐电压Voltage proof	1 minute at AC 300V			
三、机械性能: Mechanical characteristics					
序号NO.	项目 ITEM	性能PERFORMANCE			
1	全滑动止强度 Stopper Strength	3kgf. cm max. /3sec. From the base level to a point of 2mm			
2	作动力 Operating Force	10~200gf. cm			
3	C. C. 脱出力 Click slip-	20~250gf. cm (only center click)			
4	轴心摇动接受力 Lever Push-Pull	2(2*L)/25mm max. (L: lever length both side)			
5	滑动柄摇晃度 leve wobble	1.6mm Max (both sides)			
四、耐久性能: Anti-permeability					
序号NO.	项目 ITEM	性能PERFORMANCE			
1	滑动寿命 Rotational life	无负荷时, 每小时600周, 10000 \pm 200周后阻值变化不超过 \pm 15%。 Permissible resistance change after 10,000 \pm 200 cycles on 600r.p.h. without load \pm 15% max.			
五、焊锡方式: Solder way					
序号NO.	项目 ITEM	性能PERFORMANCE			
1	手工焊锡 Manual welding	300 $^{\circ}$ C \pm 10 $^{\circ}$ C 3S \pm 1S			
2	波峰焊接 Wave soldering	250 $^{\circ}$ C \pm 10 $^{\circ}$ C 4S \pm 0.5S			

未指定容許±尺寸之公差

10以下	±0.3
10~100	±0.5
100以上	±0.8
角度	±5°

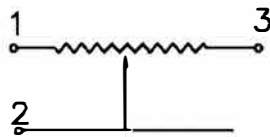
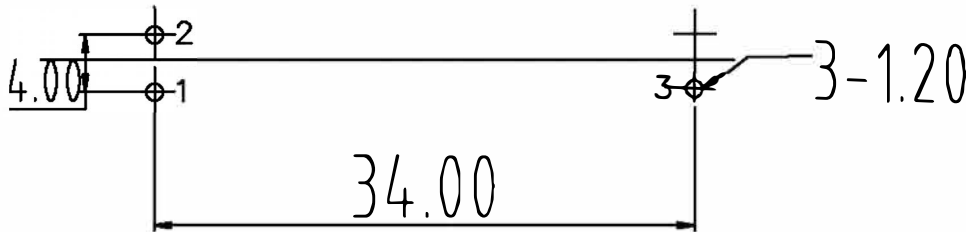
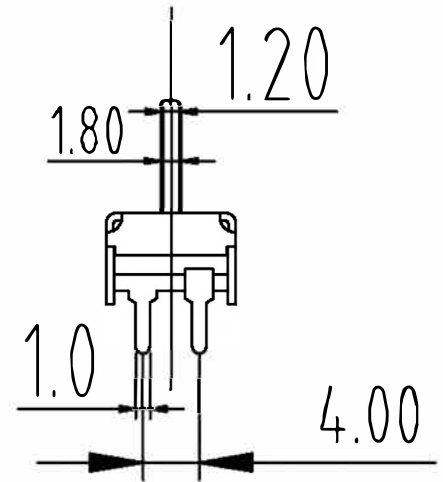
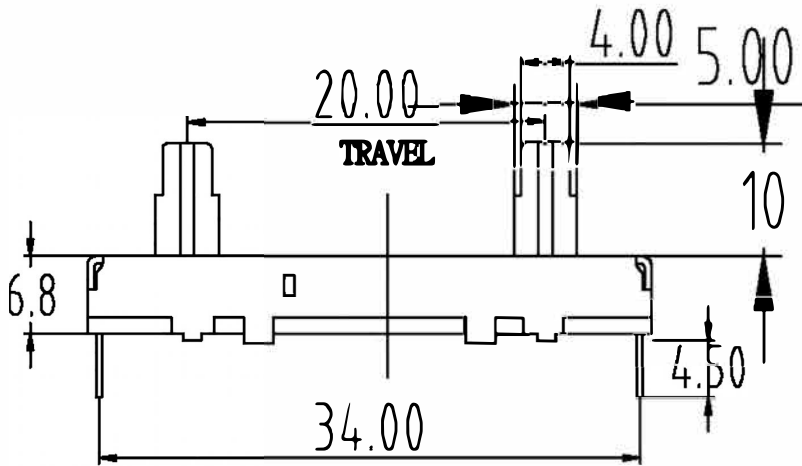
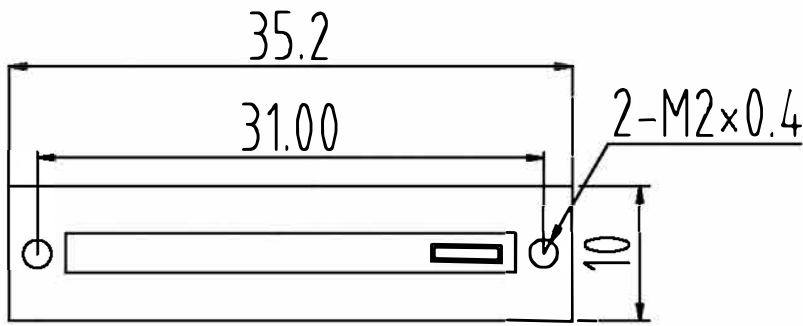

CIRCUIT

C-TYPE

C-TYPE

CA-TYPE

B-TYPE

CB-TYPE

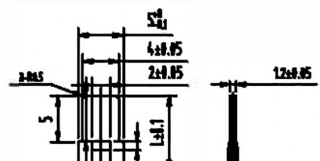
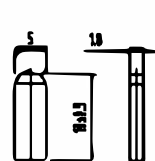
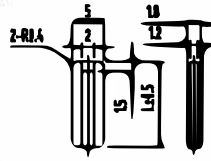
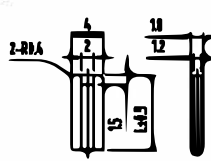
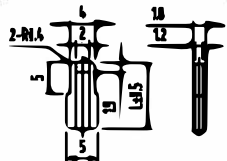

L 10 12.5 15 18 20 L 5

L 5 8 10

L 10

L 9.7

MTL

SPEC

DISPOSAL

Title



MM

Scale

1/1

1

2

3

4

5

6

Dwg Name

DESIGN

李沛熙

Dwg No.

CHECK

CC-TYPE

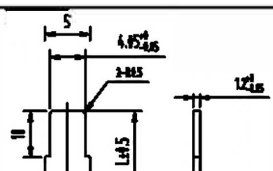

L 15