

REV. 更改	DESCRIPTION 说明	ENG. 修改人	APPROVE 审核

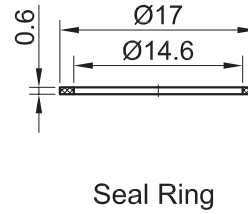
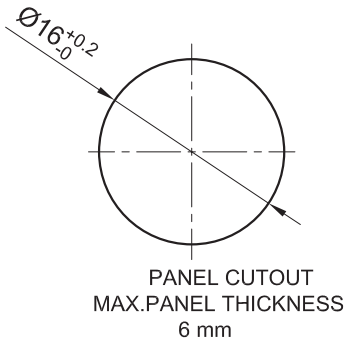
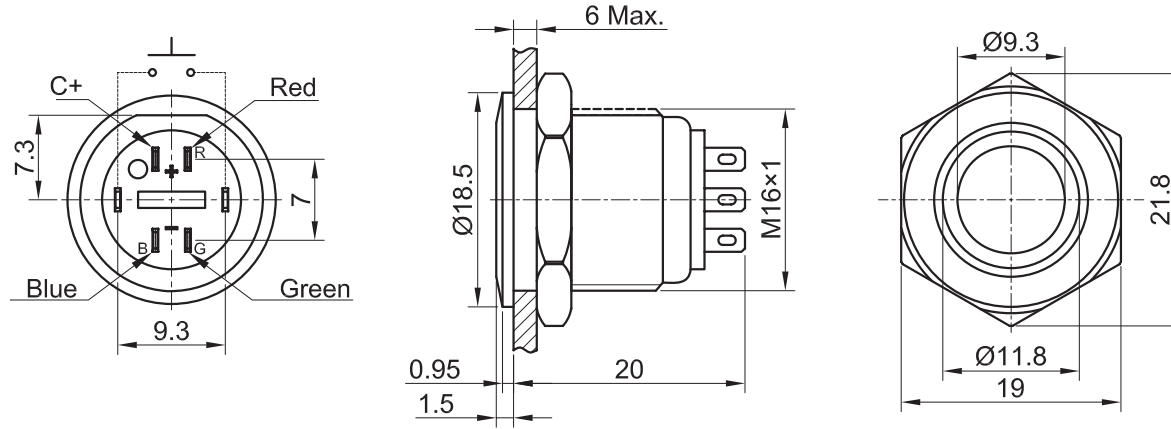

SPECIFICATIONS:

- 1.Rating: 2A 36VDC.
- 3.Electrical Life: $\geq 200,000$ cycles.
- 4.Contact Resistance: ≤ 50 m Ω .
- 5.Insulation Resistance: $\geq 1,000$ M Ω .
- 6.Dielectric Strength: 2,000V RMS 50Hz.
- 7.Operating Temperature: -25 $^{\circ}$ C ~ +55 $^{\circ}$ C.
- 8.Operating Force: About 4N.
- 9.Torque: 0. Nm max.applied to nut.
- 10.Contact Configuration: 1NO.
11. Operation Type: Momentary.
- 12.IP Class: IP67.
- 13.LED color: Red, Green, Blue.
- 14.LED voltage: 6V.

MATERIALS:

- 1.Contact: Silver alloy.
- 2.Button: Stainless Steel.
- 3.Body: Stainless Steel.
- 4.Base: PBT.

Part Number: PM161F-10E / RGB / 12V / S / IP67

DIMENSIONS		TOLERANCE	SCALE	UNIT	DR.	
0.00 TO 30.00mm		± 0.20 mm	比例 1.5 / 1	mm	制图 HMJ 2016/05/19	
30.01 TO 80.00mm		± 0.25 mm				
80.01 TO 150.00mm		± 0.30 mm				
150.01 ↑		± 0.40 mm				
MATERIAL			DWG NO.	SIZE		
			图号 PM161F-10E / J / RGB / 12V / S / IP67	图号 A4		
			FILE NAME	SHEET	REV.	
			档案名称 PM161F-10EJRGB12VS IP67.DWG	张 1 / 1	更改 1	