

**RoHS Compliant**

Specifications:  
 Material And Finish:  
 Insulator:PBT UL94V-0 Color:Black  
 Contact:Brass  
 Plated:See Ordering Information

Rating:  
 Current Rating:3.0 Amp  
 Voltage Rating:250V AC/DC  
 Operating Temperature Range:-40~+105°C

Electrical:  
 Contact resistance:30m Ohm Max  
 Insulator resistance:1000M ohm min.  
 Withstanding Voltage:500V AC/Minute

Ordering Information  
 CP25411-XXX-S100-X

A:In bag  
 B:In Tube  
 S:Straight Type  
 G:Gold Flash  
 C>Contact:Gold 10u"/Soldertail:Gold Flash  
 T:Tin Plated  
 No. of Positions

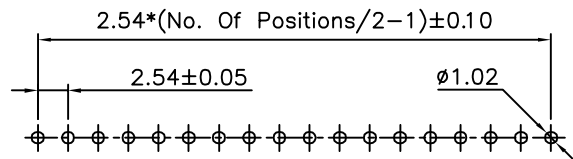
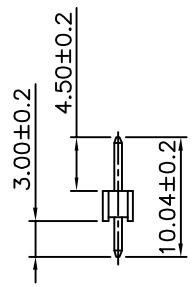
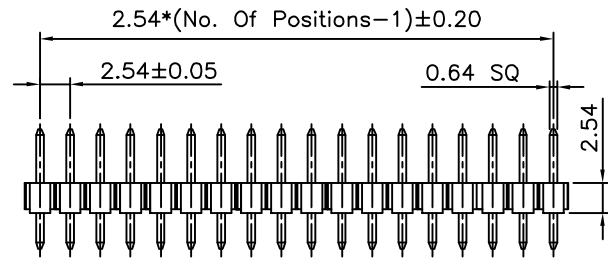
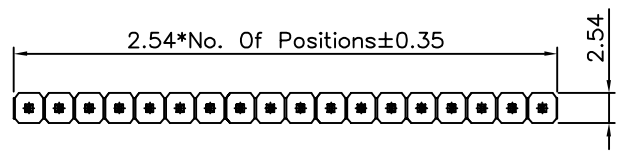

(Tolerance:0.05)  
 Recommended PCB Layout

A5				DR.BY.: <b>Tom Liu</b>	TITLE : 2.54mm Pitch Pin Header Straight Type	GENERAL TOLERANCE:						
A4				CHKD.: <b>Jack Wu</b>	PART NO : CP25411-XXX-S100-X	LINEAR	ANGLES				X.: ±0.30	X': ±5.0'
A3				APPD.: <b>Kane He</b>	DWG. NO.: CXRD150625-004	X.X: ±0.20	X.X': ±3.0'	X.XX: ±0.15	X.XX': ±2.0'			
A2	ORIGINAL	<b>Tom Liu</b>	Jun-25-2015		DATE: Jun-25-2015	X.XXX: ±0.10	X.XXX': ±1.0'	UNIT: mm	SCALE: 1:1	SHEET: 1/1		A4
REV.	ECN. NO.	DR.BY	DATE								THIRD ANGLE PROJECTION	