

## 1 Remove Rubber Band

Pick up the Pocket Socket and remove the rubber band. (You may hold the Pocket Socket in either hand.)

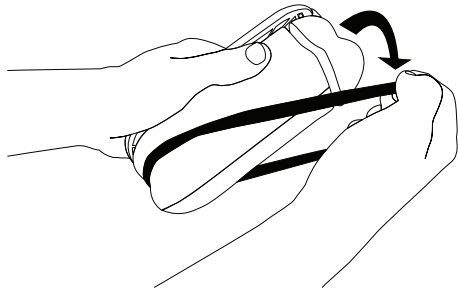

Keep the rubber band nearby.

## 2 Open Handle

Turn the handle 180 degrees so that it is facing away from the generator body, it will 'click' into place.

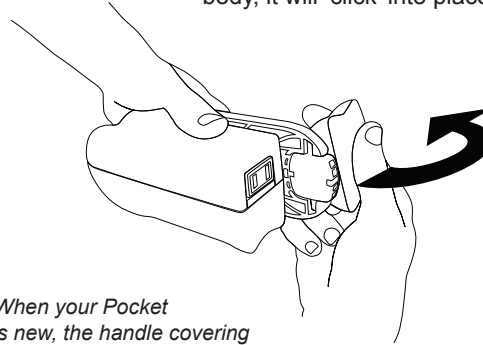

**NOTE:** When your Pocket Socket is new, the handle covering the outlet may be a little stiff, it will loosen up with use.

## 3 Plug in Your Device

Plug the device or charger you want to power into the socket\*

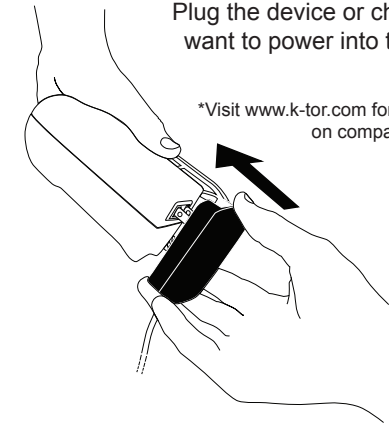

\*Visit [www.k-tor.com](http://www.k-tor.com) for information on compatible devices

**NOTE:** The Pocket Socket works with a variety of outlet adapters. Visit [www.k-tor.com](http://www.k-tor.com) for more details.

## 4 Replace Rubber Band

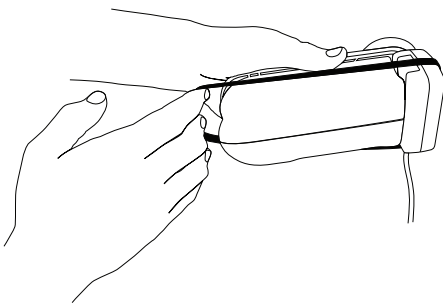

When applicable, replace the rubber band securing the device in the socket. More rubber band tips and tricks are available online: [www.k-tor.com/pocket-socket-demo](http://www.k-tor.com/pocket-socket-demo)

## 5 Prepare For Operation

**CAUTION!** Ensure you can safely rotate the arm without striking yourself, anyone else or any other object.

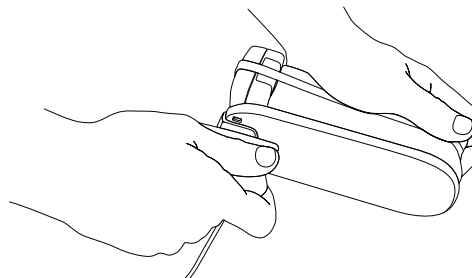

You may hold the Pocket Socket in either hand and spin in either direction to generate electricity. The Pocket Socket can power devices with a power rating up to 10W and will generate electricity when you are spinning the crank arm above the minimum rate.

## 6 Spin at 2 rev/sec

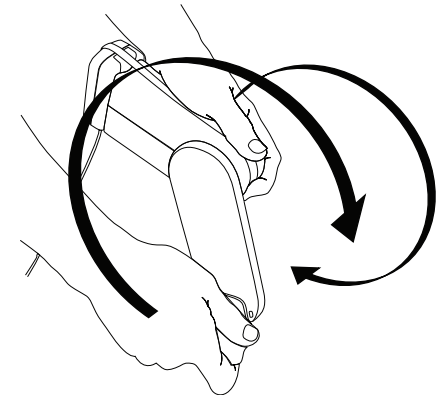

Spin at a rate of at least 2 revolutions per seconde to begin powering your device or charger. You may spin faster than 2 rev/sec if it is comfortable.



CONNECTED TO THE INTERNET?



**PLEASE WATCH THE ONLINE DEMONSTRATION VIDEO  
PRIOR TO USING THE K-TOR POCKET SOCKET**

**[www.k-tor.com](http://www.k-tor.com)**



**READ BEFORE OPERATING**

(INSTRUCTIONS - TURN OVER)



**TURN 2 CRANKS PER SECOND  
TO CHARGE YOUR DEVICE**

**GRIP  
HERE**

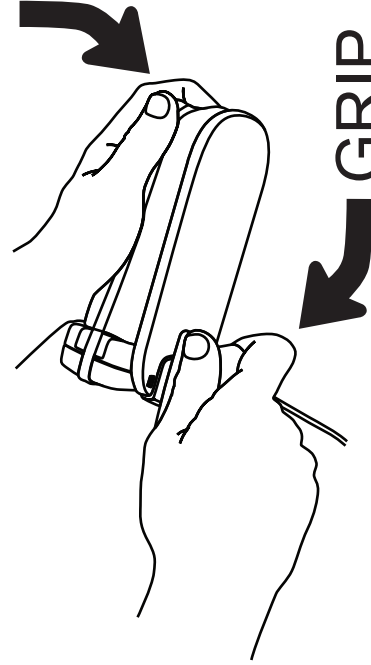

**GRIP  
HERE**

**TAKE BREAKS!**

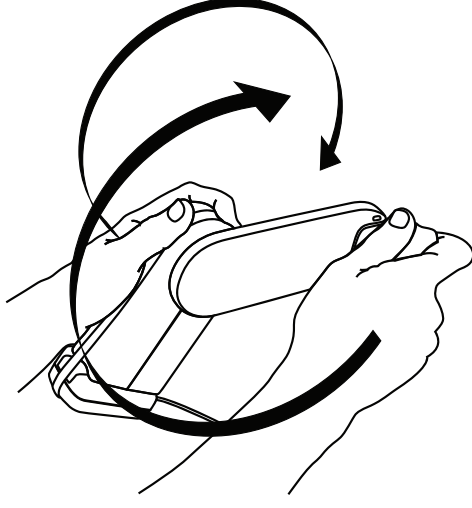

**REST AFTER 3-5 MINS OF  
CRANKING, OR AS NEEDED.**